

AVAILABLE LIGHT

Museum at Prairiefire

Overland Park KS



The Museum of Prairiefire is a new natural history museum in Kansas based on a partnership with the American Museum of Natural History. When designing the exterior, the architect wanted to evoke the memory of prairie fires. To achieve this effect, the retaining walls in the landscape were uplit with color-changing lighting programmed to evoke the low fire line of a prairie fire. The building is illuminated with concealed color-changing uplight with more active flames. The whole effect is programmed to read as a single composition evoking prairie fire.

The lobby presented a challenge with its high spaces and complex ceiling planes. The lighting system needed to be flexible as well. Track lighting was installed concealed in the perimeter slot where the ceiling meets the walls, and a series of color-changing uplights highlight the unique ceiling. This put all of the lighting within reach on the outer wall of the lobby.

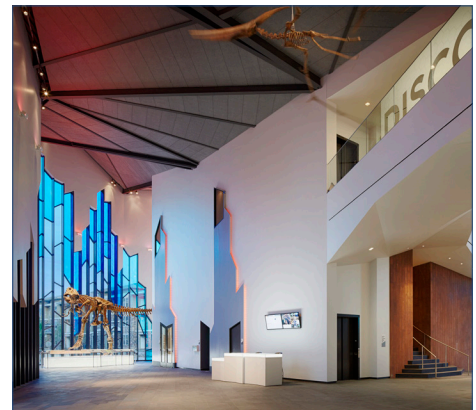

Architect: Verner Johnson
Completed: 2014
Photos by: Michael Robinson, Sam Fentress